

# BREIDEGAM CENTER

## Semi-Private Floor Plan

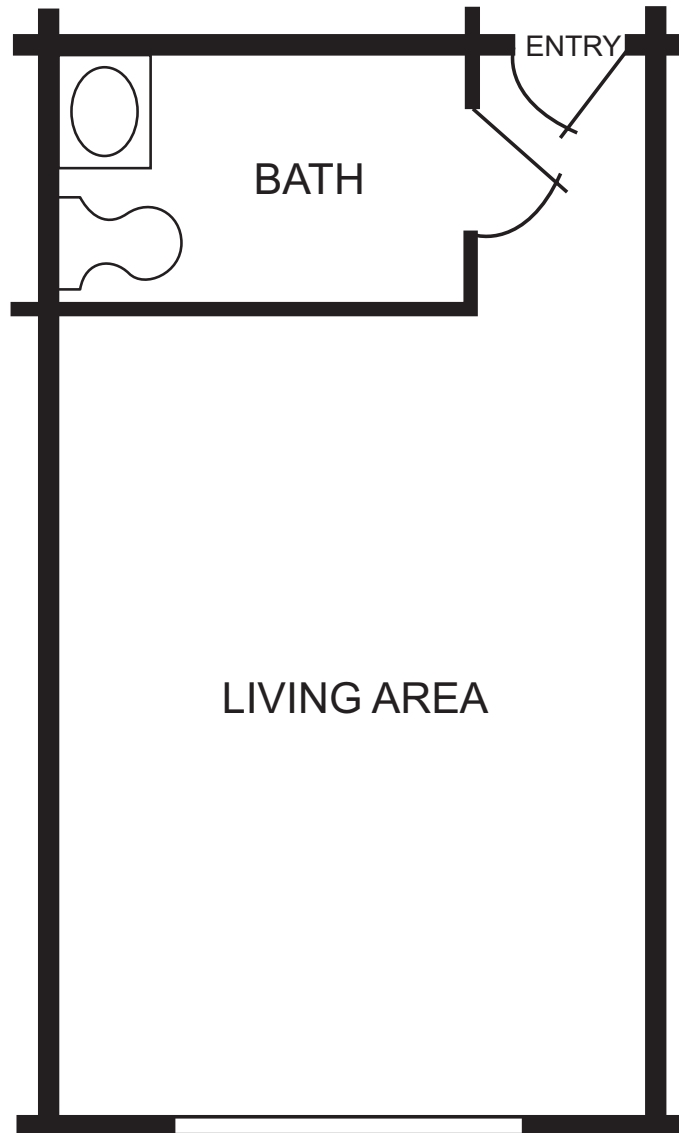

*Approximately 350 sq. ft.*



**THE LUTHERAN  
HOME AT TOPTON**

A DIAKON SENIOR LIVING COMMUNITY

One South Home Avenue  
Topton, PA 19562

Phone 610.682.1400  
Toll Free 800.322.9597  
Fax 610.682.1581

[www.diakon.org](http://www.diakon.org)