

LUTHER CREST *Lifestyles*

SPRING
ISSUE
2009

CHAPLAIN LEARNS FROM THOSE SHE SERVES

Dianne Kareha likes to meet new Luther Crest residents over dinner and some casual conversation. The informal encounter is one of many opportunities that she has, as community chaplain, to share in their journey, no matter what their faith.

"I love the residents," says Kareha, who has served Luther Crest for more than 16 years. "I feel as if I'm on holy ground [when I'm with them]," she says. "The people teach me a lot about life and faith."

Today, Kareha serves the community full-time, offers worship service and Bible study for three levels of service, and coordinates additional activities throughout the week. She also leads a weekly scripture study in which participants ask themselves how the readings apply to everyday life.

"The question becomes, what does this have to do with us today?" she says, adding that there is no right answer. "[Their answers] are as different as the people and their experiences." *Please turn to page 2.*

When Kareha joined Luther Crest in 1993, her duties fit nicely into a part-time work schedule.

2 Membership Privileges

Start enjoying the amenities before you even move in

3 Reserve Now!

These luxury apartments are going fast

4 New Wellness Center

Wellness is one of several top priorities at Luther Crest



LUTHER CREST

A DIAKON LUTHERAN
SENIOR LIVING COMMUNITY

A NOTE FROM THE EXECUTIVE DIRECTOR



Although winter may be a traditional time to wind down, Luther Crest, a Diakon Lutheran Senior Living Community, is in full swing with many lifestyle enhancements under way.

With the first floor of the Wellness Center and indoor pool now open, we have expanded our fitness offer to include strength training, and aquatic exercise and training. Our new game room has an indoor shuffleboard court, and our residents have already started a group for competitive play.

In addition, our gift shop has opened temporary quarters in the Wellness Center while its permanent location is under construction. It is anticipated that the Wellness Center will have its grand opening this spring.

This past year we have been challenged with the task of replacing all of the roofs in our Upper Commons, dining room, and kitchen area. Rather than wait two years to renovate the Upper Commons, the decision was made to incorporate a full renovation of the area as we replace each roof. When the dust settles, we will have a new formal and informal dining offer, a renovated library, gift shop, receptionist area, main entrance, resident mail/clerk area, and new and renovated office space.

Once that project is complete, we will begin renovations to Crest Hall (our auditorium), our private dining room, and our Bistro.

I invite you to learn more about what is happening at Luther Crest and to stop in for a visit. The best way for you to understand the evolution under way is for you to visit our campus. I look forward to meeting you!

Jeanne Oski

EXECUTIVE DIRECTOR

Continued from front cover

Kareha nurtures those differences every Sunday by inviting pastors from the community to lead the worship services. Although she may share in the worship leadership, she welcomes the visiting pastors' fresh voices, ideas, and different faith traditions.

"I recognize that this work is not about me," she says. "It is about God, the people, and our relationship with God."

CHARTER MEMBERSHIP HAS ITS PRIVILEGES

Be among the first 70 percent to place a deposit on a Bridgegate apartment, and you can start enjoying the rewards of the Bridgegate lifestyle even before you move in.

As a charter member, you lock in preconstruction prices and receive money toward upgrades. Charter members also have access to all Luther Crest facilities—including the new Wellness Center, dining and indoor pool facilities—prior to Bridgegate's opening in 2010.

Member benefits include:

- Guaranteed selection of floor plans
- Pre-construction pricing
- \$1,500 credit toward options and upgrades
- Three hours of moving assistance
- Free Wellness Center membership
- Free monthly guest meals before move-in
- Guest privileges at all campus activities and special events

Call Bridgegate today at (610) 391-8229 or, toll-free, at 1-800-606-3424 to learn more.

If you are interested in exploring the possibility of active senior living at Luther Crest, contact John Kotsatos today at (610) 391-8227 or toll-free at 1-800-606-3424.

RESERVE NOW. BRIDGEGATE SET TO OPEN IN 2010

SAMPLE APARTMENT LIVING IN BRIDGEGATE MODEL

Active adults looking forward to life within Bridgagate at Luther Crest have already reserved nearly 30 percent of the 42 new luxury apartments that will connect them with all the amenities and conveniences on the Luther Crest campus.

Excavation is under way for this next phase of expansion at Luther Crest, with an anticipated opening date of spring 2010.

Designed for comfort and convenience, Bridgagate will offer five unique apartment styles, connected by beautifully decorated, climate-controlled hallways and lounge areas to the amenities and conveniences of Luther Crest's Community Center. With options such as breakfast bars, dens, open floor plans, patios, and extra large walk-in closets, there is a one- or two-bedroom floor plan that will suit the way you live.

If you wonder what the Bridgagate lifestyle is all about, plan now to visit the newly opened model apartment.

With 1,300 square feet of living space, the model provides an excellent opportunity to envision this new phase of senior living. You also can experience the various options available in Bridgagate, including architectural styles, flooring, switches, light fixtures, counter tops, and cabinetry.

The model apartment will remain open throughout the construction process. For more information about Bridgagate or to schedule a visit, please contact John Kotsatos at (610) 391-8227.

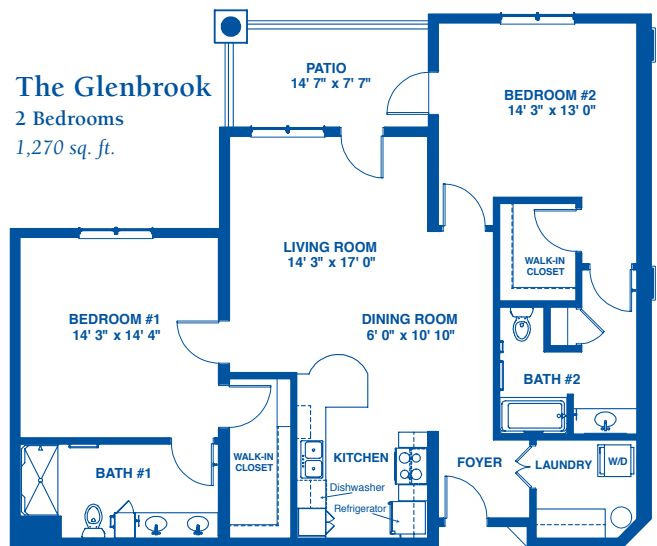

LUTHER CREST

A DIAKON LUTHERAN
SENIOR LIVING COMMUNITY

LUTHER CREST OFFERS A BETTER PATH TO WELLNESS

The new Wellness Center at Luther Crest offers residents an exciting array of services and amenities to promote well-being.

The center's ground floor is anchored by a three-lane swimming pool and includes an expanded fitness center with both cardio and strengthening equipment, as well as a multi-purpose room. An artistic crafts room, massage therapy area, and clinic, to be used for services such as physician appointments, blood-pressure screenings, and nutritional consultations, will open this spring.

A new library, designed with the help of residents, will be housed on the first floor of the Wellness Center. In addition to a relaxing sitting area and expanded book selection, the library will include a work area complete with two computers, a machine that benefits the visually impaired, and a work table. A Welcome Center and renovated offices for administration and marketing staff complete the first floor; this area will open in April.

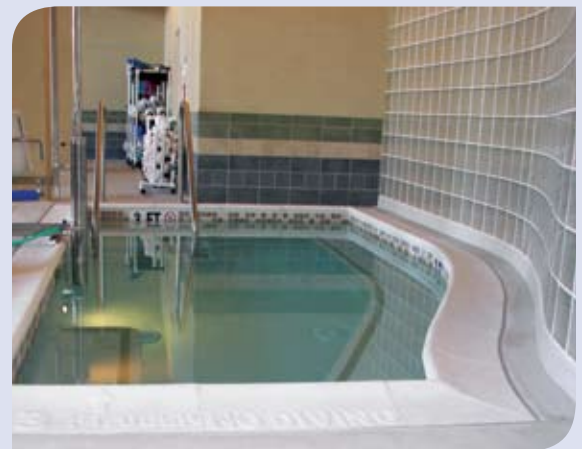

LUTHER CREST

A DIAKON LUTHERAN SENIOR LIVING COMMUNITY

800 Hausman Road
Allentown, PA 18104